

CITY OF COLLEGE PARK, MARYLAND

Request for Bid Proposals CP-18-02

Hollywood Gateway Park Project – Addendum #3

March 14, 2018

This addendum shall become a part of the Contract Documents for CP-18-02. Bidders must acknowledge receipt of this Addendum in the space provided on the Bid Proposal Form. Failure to do so may subject Bidders to disqualification.

Addendum Items: The following additional questions have been received and are answered below.

1. Q: Will the “Master Unit Price Bid Item” form be used for pricing for modifications to the contract, or is this for bid breakdown detail only? Could these be used for add alternates or deductions to the contract?

A: The Master Unit Price Item will be used for the basis of changes in the work in accordance with General Conditions, Section J. “Changes in the Work.”

2. Q: Bid Response Package, page 39. List of Deduct Alternates, 300D Aluminum Edging – the example of the deduct wanted for this section is confusing, please clarify the deduct scope of work wanted. Also, 400 Planting – the example of the deduct will actually be an “add.”

A: The deduct alternate includes the slope slide and all components associated with the slide: slide, mulch surfacing and aluminum edge for mulch surfacing. Should the deduct alternate be accepted, the following components need to be added: planting where the slide would have gone and continuation of the handrail where the slide would have been installed.

3. Q: Drawing C-3.4, Sequence of Construction, Notes I through II show 62 days duration to the final completion of the contract. The contract duration is 180 days as confirmed at the pre-bid meeting.

A: The contract duration is 180 days.

4. Q. In the Addendum I drawings, Note N-8 on sheet C-2.1 states, “New Concrete Ramp with Handrails.” This note is called out at all areas of concrete work including the “patio area” at the steel structure, and both of the sidewalks along the streets. As I believe the handrail portion of this note should only apply to the sloped ramp, could you clarify the extent of “handrail” required in note N-8?

A: The attached drawing will clarify the extent of the handrails. They are just along the linear ramped walks and landing except where discontinued for the fieldstone stairs and slope slide. The patio area and sidewalks along the streets are not included.

Please note that the date for bid submissions has been extended to March 30, 2018 at 2:00 pm.

THIS CONCLUDES ADDENDUM #3 TO CP-18-02 ISSUED MARCH 14, 2018

NO.	DATE	REVISION
1	03/02/2018	ADDITION #1
BY		MSE/MB

3000 HUNTERS LANE, SUITE 200
 BELTSVILLE, MARYLAND 21054
 TEL: 410.228.8255
 FAX: 410.228.8255

WBCM
 ARCHITECTURE ENGINEERS CONSTRUCTION

FLORA TETTER
 A Joint Venture
 WHITNEY BAILEY COX & MAGNANI, LLC

CITY OF COLLEGE PARK MARYLAND
 4709 EDGEMOOD ROAD
 COLLEGE PARK, MARYLAND

HARDSCAPE PLAN
 BID SET

DRAWN: DWK/2MB
 CHECKED: TJA
 DATE: 03/02/18
 PROJECT: 2012.03.00.00
 DRAWING: LD-1.00

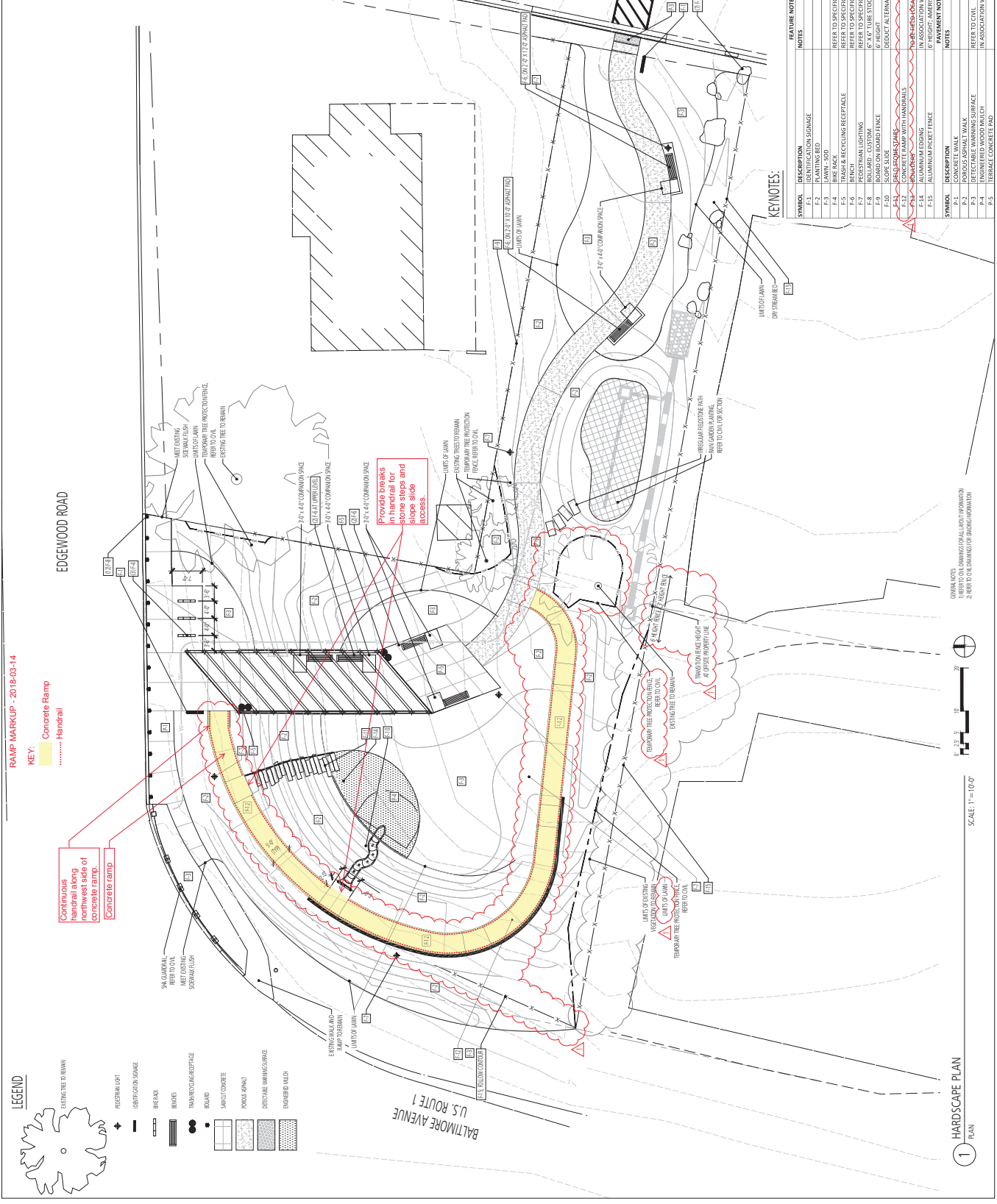

SYMBOL	DESCRIPTION	NOTES	REFERENCE
F-1	IDENTIFICATION SOURCE		4-10-D-3.00
F-2	BRICK		4-10-D-3.00
F-3	LAWN, SOO		210-D-3.10
F-4	BIKE RACK	REFER TO SPECIFICATIONS	
F-5	TRASH & RECYCLING RECEPTACLE	REFER TO SPECIFICATIONS	
F-6	PRESTRAIN LIGHTING	REFER TO SPECIFICATIONS	
F-7	BRICK	REFER TO SPECIFICATIONS	
F-8	ROLLBACK - CUSTOM	REFER TO SPECIFICATIONS	
F-9	ROAD SIGN BOARD FENCE	6" X 6" TUBE STOCK TO MATCH PAVILION	
F-10	ROAD SIGN BOARD FENCE	6" HEIGHT	
F-11	CONCRETE RAMP WITH HANDRAILS	6" X 6" TUBE STOCK TO MATCH PAVILION	
F-12	CONCRETE RAMP WITH HANDRAILS	6" HEIGHT	
F-13	ALUMINUM DOORS	IN ASSOCIATION WITH PRODUCT ALTERNATE #1	
F-14	ALUMINUM DOORS	6" HEIGHT, AMERISTAR OR APPROVED EQUAL	
F-15	ALUMINUM DOORS	IN ASSOCIATION WITH PRODUCT ALTERNATE #1	
F-16	CONCRETE WALK		
F-17	POPPUS ASPHALT WALK		
F-18	POPPUS ASPHALT WALK		
F-19	DETECTABLE WARNING SURFACE		
F-20	DETECTABLE WARNING SURFACE		
F-21	TERRAZE CONCRETE PAD		

RAMP MARKUP - 2018-03-14

SCALE: 1"=10'-0"

1 HARDSCAPE PLAN